

Schlüter®-KERDI-FIX

Installation adhesive
for connections and abutments

8.3

Product data sheet

Application and Function

Schlüter®-KERDI-FIX is an elastic installation adhesive made of an MS polymer. It is suitable for creating tight seals at the transition between bonded waterproofing assemblies made with Schlüter®-KERDI and other construction elements such as balcony and terrace doors, window components, metal ducts or Schlüter®-BARA edge profiles. Furthermore, Schlüter®-KERDI-FIX is ideally suited for joining Schlüter®-KERDI-BOARD panels or for adhering them to construction fixtures. Schlüter®-KERDI-FIX can also be used for adhering other materials.

Material

Schlüter®-KERDI-FIX is a single component waterproofing and adhesive compound based on silane modified polymers. The material is not classified as hazardous and may be disposed under the waste code 080499.

Material properties and areas of application

Schlüter®-KERDI-FIX is odourless, resistant to UV radiation and weather influences and is therefore especially suitable for use in outdoor areas. The adhesive is elastic, free of solvents and has good adhesion to most materials such as wood, stone, concrete, metal, glass and many synthetic materials. Schlüter®-KERDI-FIX can be used as an adhesive and waterproofing compound and is also suitable for connection joints and expansion joints.



Schlüter®-KERDI-FIX can be painted over with most dispersion paints. The suitability of the material must be verified based on the anticipated chemical, mechanical and/or other stresses.

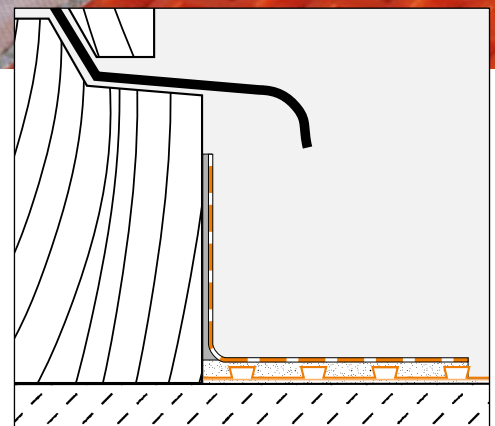



Installation

1. The substrate may be slightly moist but must be free of components that may impede adhesion. In addition, it should be sufficiently solid and able to bear weight.
2. Apply Schlüter®-KERDI-FIX to the substrate. To attach Schlüter®-KERDI, spread the installation adhesive evenly with a small notched trowel.
3. Adhere the construction material as quickly as possible over the whole area, making sure to avoid the formation of air bubbles.
4. When installing Schlüter®-KERDI it is recommended to run the smooth side of the notched trowel over the Schlüter®-KERDI mat at an angle under pressure or to use a suitable pressure roller to carefully avoid air bubbles.

If Schlüter®-KERDI-FIX is used as grout, immediately smooth the surface after filling the joint. The surface of the joint should be cleaned at regular intervals.

Cleaning: Remove fresh adhesive with cleaning agent; after curing, the adhesive can only be removed with mechanical methods.

Maintenance

Storage

Store unopened packages of Schlüter®-KERDI-FIX in a cool location above freezing temperatures. Cartridges may be stored for 18 months, squeezable tubes for 12 months. Open cartridges have limited storage life.



Required amounts of Schlüter®-KERDI-FIX

- 5 cm connection to upright construction fixtures:
Consumption/m approximately = 45 g
Yield per cartridge = 10 m

Product Overview

Technical data

Colour	grey/brilliant white
Basic raw material	silyl modified polymer (SMP)
Specific weight	approximately 1.5 g/ml
Solvent content	0%
Isocyanate content	0%
Dry materials content	approximately 100%
Shear strength beech wood/beech wood	approximately 3 N/mm ²
Sheer strength aluminium/aluminium	approximately 2 N/mm ²
Elongation at failure	approximately 200%
Skinning	about 10 minutes
Curing	3 mm per 24 hours
Permissible total movement	about 20%
Processing temperatures	do not use at temperatures below 5 °C
Temperature stability	-40 °C to + 100 °C, temporarily 180 °C (maximum 30 minutes)
Moisture resistance	very good
Frost ability	not sensitive to frost
Cartridge	420 g (290 ml)
Squeezable tube	145 g (100 ml)

Schlüter®-KERDI-FIX

G = grey, BW = brilliant white

Colour	G	BW
Cartridge 290 ml	•	•
Squeezable tube 100 ml	•	